

**PUDDING
RIVER BASIN**

**MASTER PLAN
FOR ANGLER ACCESS AND
ASSOCIATED RECREATIONAL
USES**

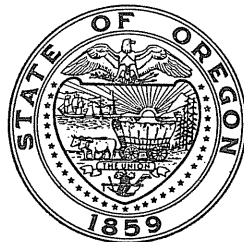

**Oregon State Game Commission
Lands Division**



PUDDING RIVER BASIN
Master Plan for Angler Access
and
Associated Recreational Uses

By

Oregon State Game Commission

Lands Section

April 1969

T A B L E O F C O N T E N T S

THE PLAN	1
VICINITY MAP	3
AREA I	4
AREA II	5
AREA III	31
APPENDIX - Pudding River Basin map		

PUDDING RIVER BASIN
Master Plan for Angler Access
and
Associated Recreational Uses

This report details a plan that we hope can be followed to solve the access problem of the Pudding River Basin. Too, we hope that all agencies that are interested in retaining existing water access as well as providing additional facilities, whether they be municipal, county, or state will all join in a cooperative effort to carry out this plan in an orderly manner. It is probable that Land and Water Conservation Funds will be available on a 50-50 matching basis. In order to acquire these funds, it will be necessary to apply through the Oregon State Highway Department.

The Pudding River Basin, located in the center of the Willamette Valley, is within close proximity to the large population centers of the Willamette Valley. Numerous highways and county roads either cross or follow the major streams within the basin making them quite accessible by vehicle.

The Pudding River and its major tributaries originate in the lower Cascade Range and flow in a northwesterly direction to enter the Willamette River 10 miles above Oregon City. Major tributaries of importance to the fishery in the basin are the Molalla River, Butte Creek, Abiqua Creek and Silver Creek.

Stream gradient is steep to moderate in the foothill sections dropping to relatively flat in the valley floor. Water quality is generally good in the upper sections of the streams. Due to the flat gradient and low summer flows

in the lower rivers, water quality is fair to poor in some sections of this area.

The major fishery within this basin is for trout, both stocked and native. In 1968, the Oregon State Game Commission stocked over 25,000 legal-sized rainbow trout into the streams covered in this report. In addition, the Molalla River also has a late run of winter steelhead available to the angler. The Molalla River has the potential to become an important steelhead stream, when the improvements to the fish passage facilities at the Oregon City Falls are completed. There is also a light warm-water fishery and limited waterfowl hunting along some areas of the lower rivers.

Access to the rivers is generally good due to the numerous roads throughout the basin, but as angling pressure increases additional stream access will be needed. Twenty-four sites have been evaluated in this access plan. Only four sites are considered complete at this time. Twenty additional sites have been recommended for procurement or for additional development to meet the present and future needs of the public.

The basin has been divided into three areas. The characteristics of each area have been described and a plan for public access is outlined in the following sections.

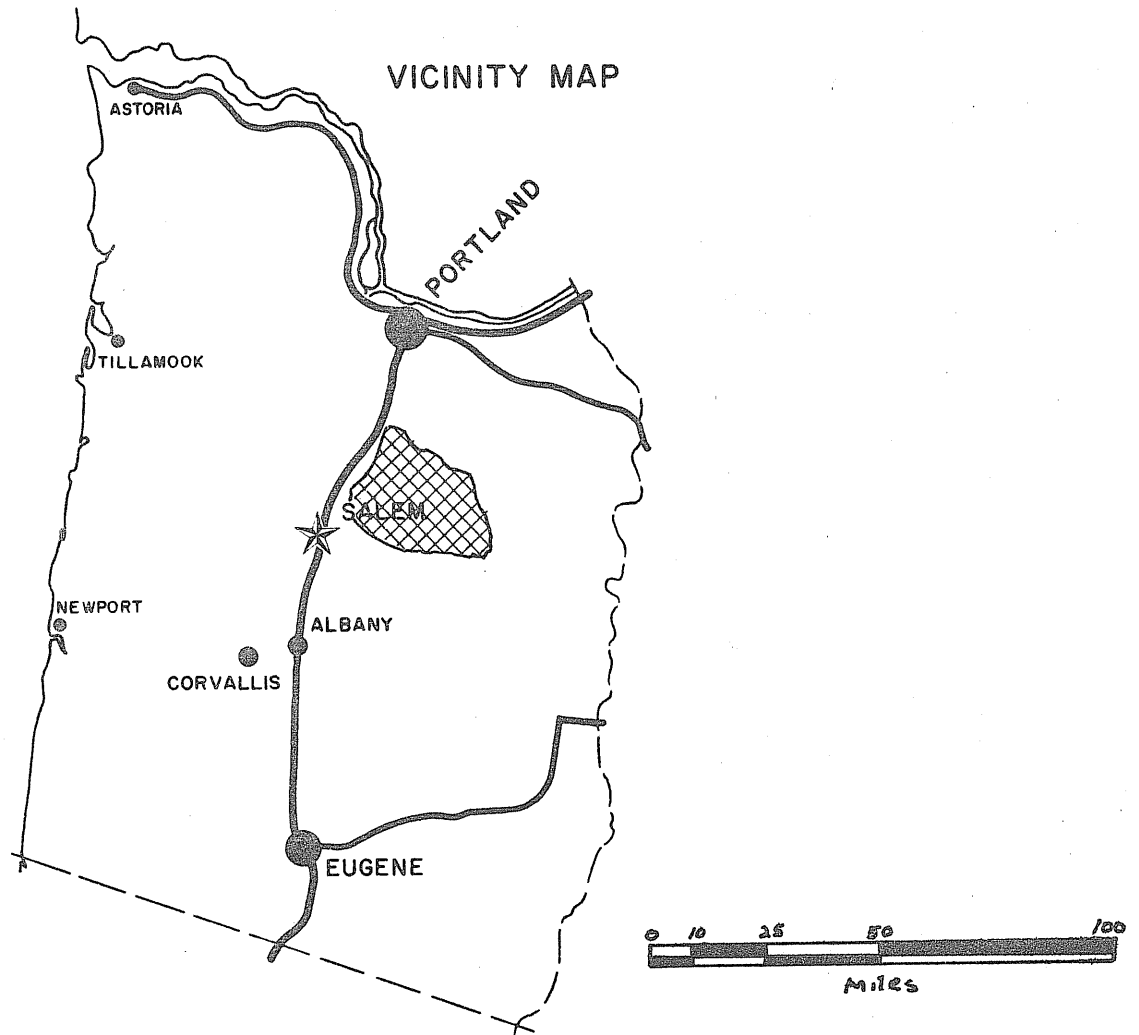

The Pudding River flows northward through the eastern portion of the Willamette Valley floor and enters the Willamette River near Canby. The river has four major tributaries which originate in the Cascade foothills and flow westward into the main river.

The major highways within the basin are U. S. Highway 99 E which crosses near the mouth of the river and State Highway 213 which transects the center of the basin. Numerous county roads, both paved and gravel, either cross or follow the major streams in the basin making them quite accessible by vehicle.

AREA I

Area I includes the lower main stem Pudding River from the mouth to river mile 45 and Little Pudding River. This entire section of the stream lies in the Willamette Valley Floor. Stream gradient is very flat resulting in a slow sluggish meandering stream. Stream banks are primarily mud with very little rock in the stream. Water quality in this section is poor due to industrial pollution, low flows and high water temperatures.

The fishery in this section of the stream consists of very light pressure on warm-water species in the main river and a light trout fishery in the upper reaches of Little Pudding River. Other recreational uses in this area include waterfowl hunting along some areas of the lower Pudding River.

Under present conditions, access on this section of the river is adequate; there are many road crossings where anglers can gain access to the stream. If existing stream conditions were improved, additional sites may be needed. No sites will be recommended at this time.

AREA II

This area includes the entire Molalla River drainage. The river originates on the west slopes of the Cascades, flows in a northwesterly direction through the Willamette Valley and enters the Pudding and Willamette Rivers 10 miles above Oregon City.

The headwater streams in the mountainous areas have a fairly steep gradient. The river in the foothill sections has an average gradient which drops to a relatively flat gradient in the Willamette Valley.

Angling in the Molalla River is primarily from the bank, although the lower river can be drifted by boat during the winter and spring. The fishery consists of trout, both native and stocked, and winter steelhead. Rainbow and cutthroat trout dominate the catch in the upper river, whereas winter steelhead and rainbow trout make up the catch in the lower river. Between 10 and 15 thousand rainbow trout are stocked annually to supplement the native trout fishery. The heaviest angling intensity occurs in the spring and summer, although the winter steelhead angling pressure has increased in recent years.

Public access within the drainage is generally good with the exception of the lower river. Boat launching sites are needed in this area to provide better access and better utilization of the areas between the interspersed public lands which are available to the anglers. Additional bank access is also needed at key areas throughout the drainage.

Twelve sites have been evaluated for this area. Only one of these sites is considered adequate at this time. A detailed description of these sites is presented on the following evaluation sheets.

WATER ACCESS SITE EVALUATION

Pudding River System Site No. 2
II Area Priority C
Name 99E Bridge Crossing

Location Molalla River - 1/2 mile south of Canby, Both Banks

T 4 S, R 1 E, Sec. 5 River Mile 3 County Clackamas

Ownership: Public State Highway Department (15-1)

Private X Tax Lot No. 15, 14 and others

Number of owners 5

DESCRIPTION

Land type Flat with moderate slopes to river

Cover type Alder and deciduous brush

Road access State Highway, Condition Paved

Flows Seasonal fluctuation Water quality Fair

Present stage of development None

ANGLER NEEDS

Acquisition: 1/2 acre for parking (use agreement) and purchase trail easement
along 1/4 mile of river frontage.

Development:

Boat ramp: Type _____ Number of lanes _____

Toilets _____ Trails X Roads _____

Parking area X; For 20 cars or _____ car-trailer units

This site is presently being used by anglers with parking along the
highway shoulder.

WATER ACCESS SITE EVALUATION

Pudding River System Site No. 3
II Area Priority A
Name Canby City Park

Location Molalla River - 1/2 mile south of Canby, East Bank
T 4 S, R 1 E, Sec. 5 River Mile 3.5-4 County Clackamas
Ownership: Public City of Canby (1-1, 2)
Private X Tax Lot No. 13, 16 and others
Number of owners 4

DESCRIPTION

Land type Large flat along river
Cover type Alder, grass and deciduous brush
Road access City Street, Condition Gravel
Flows Seasonal fluctuation Water quality Fair
Present stage of development City park

ANGLER NEEDS

Acquisition: _____ Acres, 1/2 mile _____ of frontage
Type of conveyance Purchase or easement

Development:

Boat ramp: Type Gravel Number of lanes 1
Toilets _____ Trails X Roads _____
Parking area X; For _____ cars or 15 car-trailer units

This site has approximately 1/4 mile of stream which is now available to the bank anglers. An additional 1/2 mile of trail access is recommended for this area as well as the construction of a boat ramp.

AREA II

SITE # 3

FISHERY: Steelhead and rainbow trout

	Spring	Summer	Fall	Winter
Heavy				
Medium	Tr St			
Light		Tr	Tr	Tr

(Sa - Salmon, St - Steelhead, Tr - Trout, Sg - Sturgeon, Ww - Warm Water Fishes)

SKETCH

Seasons (Check)

	Spring	Summer	Fall	Winter
Boating, motor				
Boating, non-motor	X			X
Camping, tent				
Camping, trailer				
Fishing, boat	X			X
Fishing, shore	X	X	X	X
Hiking				
Horseback riding				
Hunting, big game				
Hunting, upland game				
Hunting, waterfowl				
Nature study				
Picnicking	X	X	X	
Sightseeing				
Skin and scuba diving				
Swimming		X		
Water skiing				

RECREATION
(Check)

- Boating, motor
- Boating, non-motor
- Camping, tent
- Camping, trailer
- Fishing, boat
- Fishing, shore
- Hiking
- Horseback riding
- Hunting, big game
- Hunting, upland game
- Hunting, waterfowl
- Nature study
- Picnicking
- Sightseeing
- Skin and scuba diving
- Swimming
- Water skiing

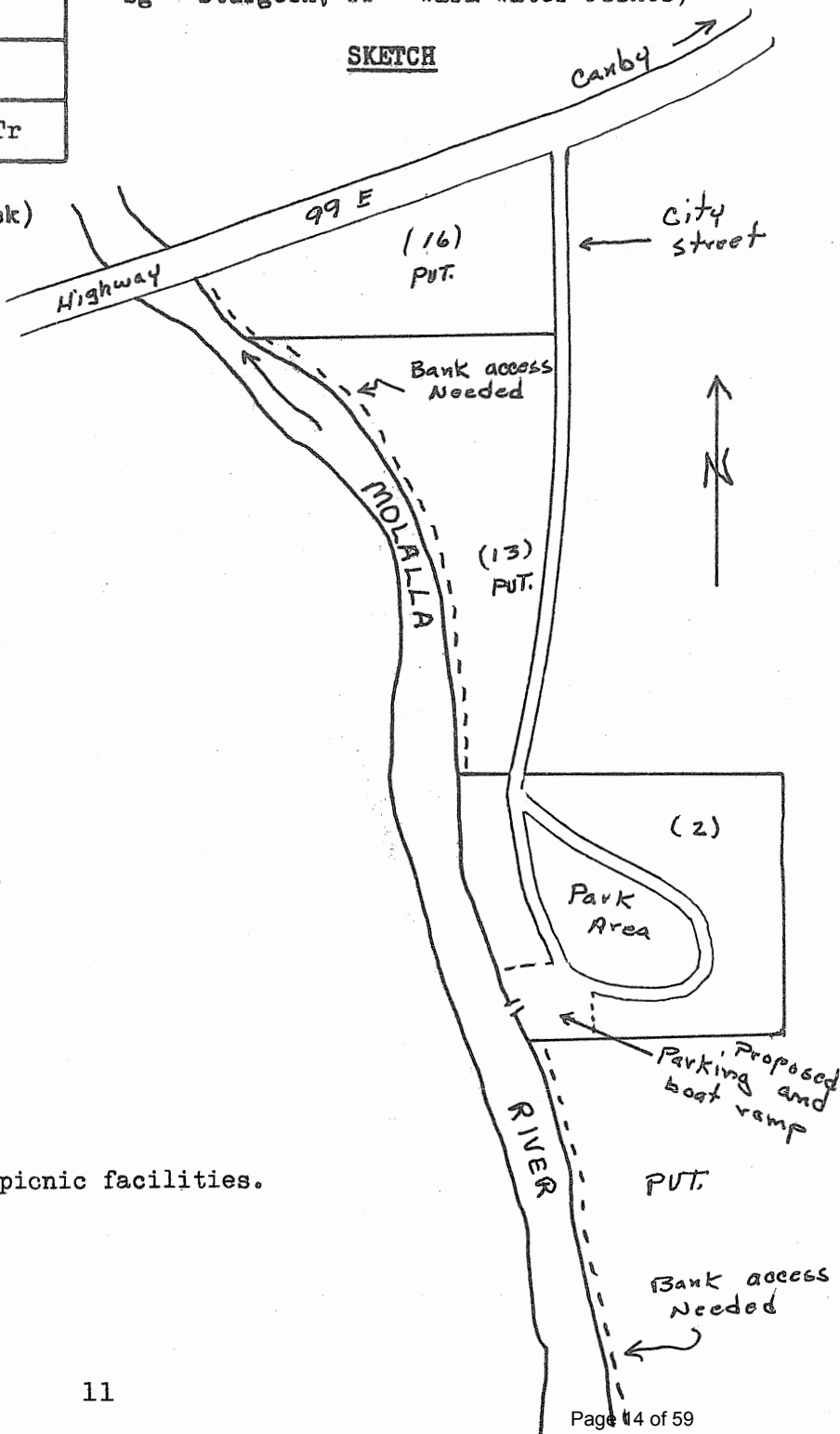

OTHER

Safety Problems:

Group Facilities: Parking and picnic facilities.

REMARKS

WATER ACCESS SITE EVALUATION

Pudding River System Site No. 4
II Area Priority B
Name Goods Bridge

Location Molalla River - 1 1/2 miles south of Canby, Both Banks
T 4 S, R 1 E, Sec. 9 River Mile 6.5 County Clackamas
Ownership: Public Clackamas County (21 & 23)
Private X Tax Lot No. 22, 32 and others
Number of owners Many

DESCRIPTION

Land type Small narrow strip along the river bank
Cover type Alder and deciduous brush
Road access County, Condition Paved
Flows Seasonal fluctuation Water quality Fair
Present stage of development None but used by bank anglers.

ANGLER NEEDS

Acquisition: 1 Acres, 1 mile of frontage
Type of conveyance Purchase and trail easement

Development:

Boat ramp: Type Gravel Number of lanes 1
Toilets X Trails X Roads X
Parking area X; For 25 cars and 10 car-trailer units
This site would provide boat launching as well as approximately 1 mile of
bank access.

AREA II

SITE # 4

FISHERY: Steelhead and rainbow trout

	Spring	Summer	Fall	Winter
Heavy				
Medium	Tr, St			
Light		Tr	Tr	Tr

(Sa - Salmon, St - Steelhead, Tr - Trout, Sg - Sturgeon, Ww - Warm Water Fishes)

SKETCH

Seasons (Check)

	Spring	Summer	Fall	Winter
	X			X
	X	X	X	X
	X	X	X	
		X		

RECREATION
(Check)

- Boating, motor
- Boating, non-motor
- Camping, tent
- Camping, trailer
- Fishing, boat
- Fishing, shore
- Hiking
- Horseback riding
- Hunting, big game
- Hunting, upland game
- Hunting, waterfowl
- Nature study
- Picnicking
- Sightseeing
- Skin and scuba diving
- Swimming
- Water skiing

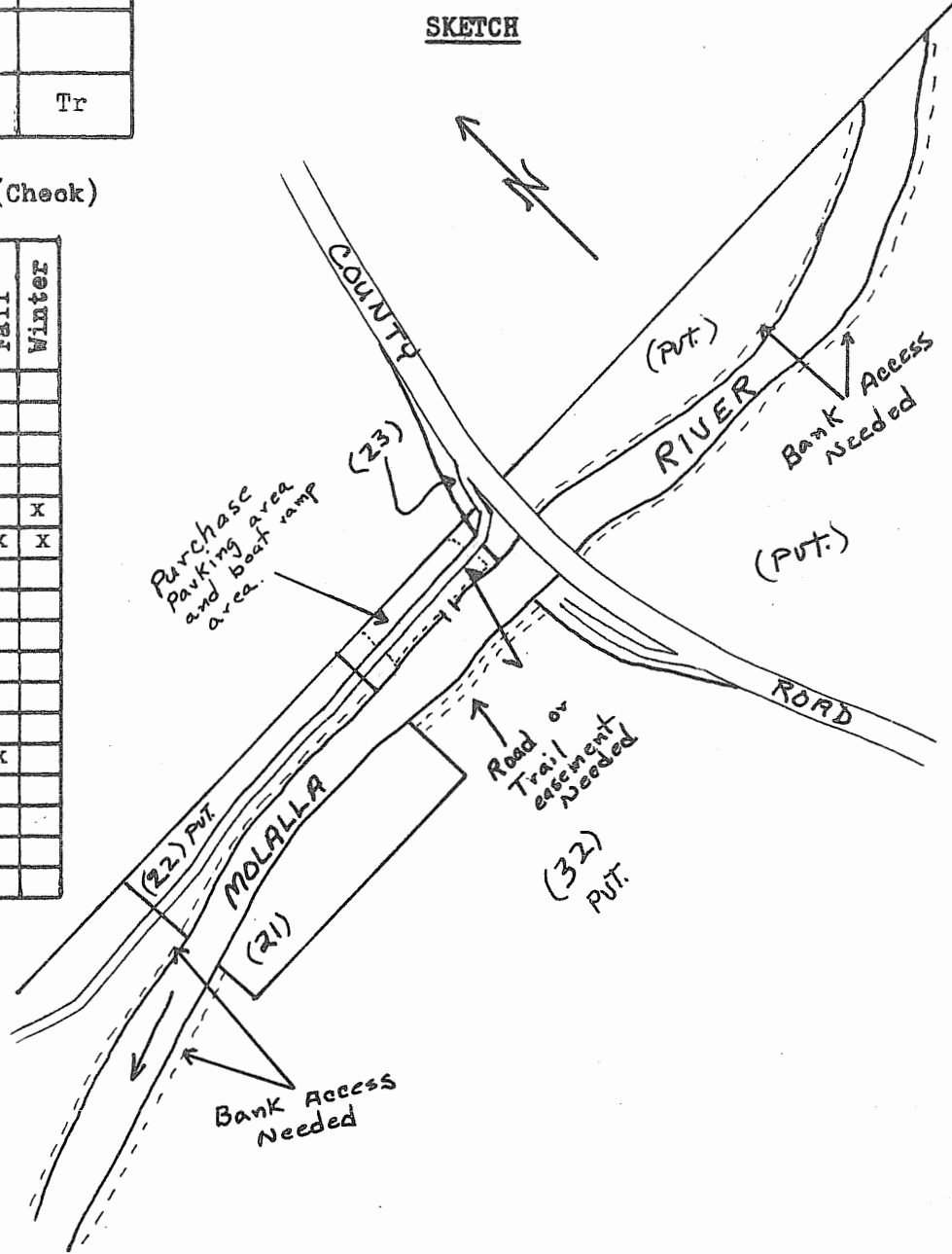

OTHER

Safety Problems:
Group Facilities:

REMARKS

WATER ACCESS SITE EVALUATION

 Pudding River System Site No. 6
 II Area Priority A
Name Wagon wheel park

Location Molalla River - 4 miles north of Molalla , South Bank
 T4 S , R 2 E , Sec. 28 & 29 River Mile 14.5 County Clackamas
Ownership: Public Clackamas County (1600 and 500 sec. 28)
Private X Tax Lot No. 600
Number of owners 2

DESCRIPTION

Land type Large flat on river
Cover type Alder, grass and deciduous brush
Road access State Highway 213 , Condition Paved
Flows Seasonal fluctuation Water quality Good
Present stage of development Complete parking and picnic area.

ANGLER NEEDS

Acquisition: Use agreement on 1 acre for parking and boat ramp - Purchase
 trail easement for $\frac{1}{2}$ mile of river frontage.

Development:

Boat ramp: Type Gravel Number of lanes 1
Toilets Trails X Roads Improvement
Parking area X ; For cars or 15 car-trailer units

 This site, as indicated on the sketch, recieved some flood damage this past
 winter and the road into the park area is in need of repair.

AREA II

SITE # 6

FISHERY: Steelhead and rainbow trout.

	Spring	Summer	Fall	Winter
Heavy				
Medium	Tr, St			
Light		Tr	Tr	St

(Sa - Salmon, St - Steelhead, Tr - Trout, Sg - Sturgeon, Ww - Warm Water Fishes)

SKETCH

Seasons (Check)

RECREATION (Check)

- Boating, motor
- Boating, non-motor
- Camping, tent
- Camping, trailer
- Fishing, boat
- Fishing, shore
- Hiking
- Horseback riding
- Hunting, big game
- Hunting, upland game
- Hunting, waterfowl
- Nature study
- Picnicking
- Sightseeing
- Skin and scuba diving
- Swimming
- Water skiing

	Spring	Summer	Fall	Winter
	X			X
	X	X	X	X
	X	X	X	
		X		

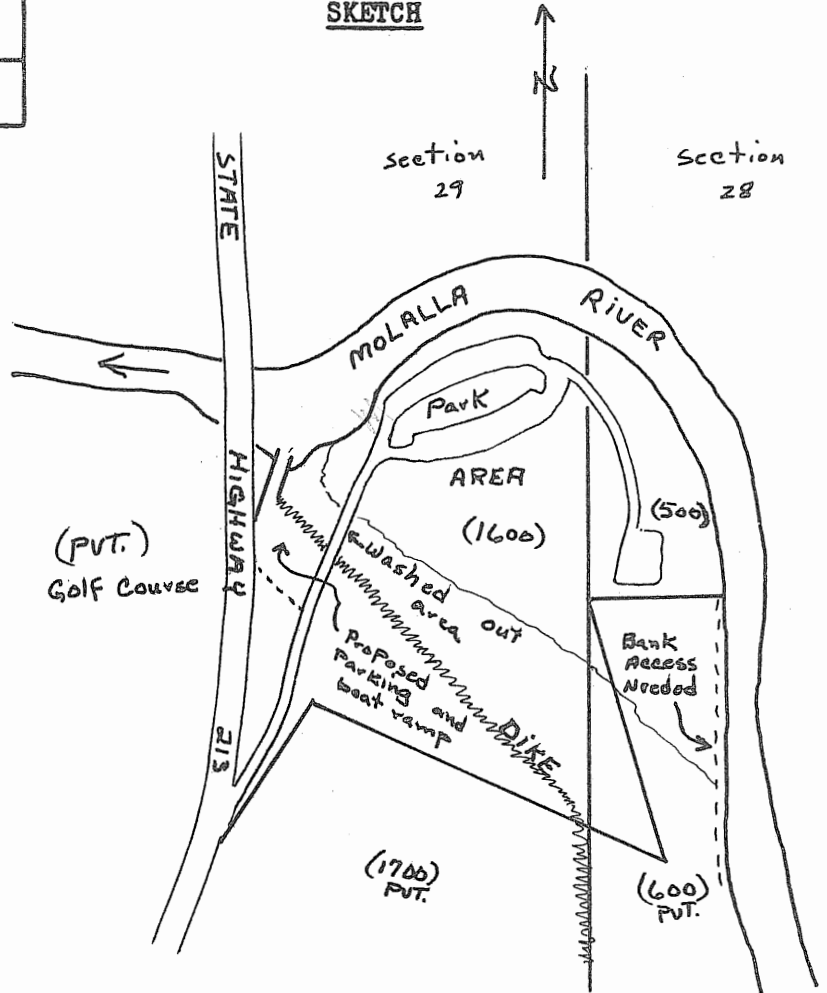

OTHER

Safety Problems:

Group Facilities: Parking and picnic facilities.

REMARKS

WATER ACCESS SITE EVALUATION

Pudding River System Site No. 7
II Area Priority B
Name Meadowbrook Bridge

Location Molalla River - 3 miles northeast of Molalla, Both Banks
T 5 S , R 2 E , Sec. 2 River Mile 18.5 County Clackamas
Ownership: Public Clackamas County
Private _____ Tax Lot No. 500, 600
Number of owners _____

DESCRIPTION

Land type Large flat along river
Cover type Alder and deciduous brush
Road access State Highway 211, Condition Paved
Flows Seasonal fluctuation Water quality Good
Present stage of development None

ANGLER NEEDS

Acquisition: 1-2 Acres, 1 mile of frontage
Type of conveyance Use agreement

Development:

Boat ramp: Type _____ Number of lanes _____
Toilets _____ Trails X Roads _____
Parking area X; For 25 cars or _____ car-trailer units

This site would provide 1 mile of river frontage for bank anglers.

WATER ACCESS SITE EVALUATION

Pudding River System Site No. 8
II Area Priority Complete
Name Feyrer Park

Location Molalla River - 2 miles east of Molalla, West Bank
T 5 S, R 2 E, Sec. 11 River Mile 21 County Clackamas
Ownership: Public Clackamas County
Private _____ Tax Lot No. 600
Number of owners _____

DESCRIPTION

Land type Large flat along river
Cover type Alder, grass and deciduous brush
Road access County, Condition Paved
Flows Seasonal fluctuation Water quality Good
Present stage of development Complete county park

ANGLER NEEDS

Acquisition: _____ Acres, _____ of frontage
Type of conveyance _____

Development:

Boat ramp: Type _____ Number of lanes _____
Toilets _____ Trails _____ Roads _____
Parking area _____; For _____ cars or _____ car-trailer units

This site provides approximately 1/2 mile of stream for bank anglers.

AREA II

SITE # 8

FISHERY: Steelhead and rainbow trout.

	Spring	Summer	Fall	Winter
Heavy	Tr			
Medium	St	Tr		
Light			Tr	Tr

(Sa - Salmon, St - Steelhead, Tr - Trout, Sg - Sturgeon, Ww - Warm Water Fishes)

SKETCH

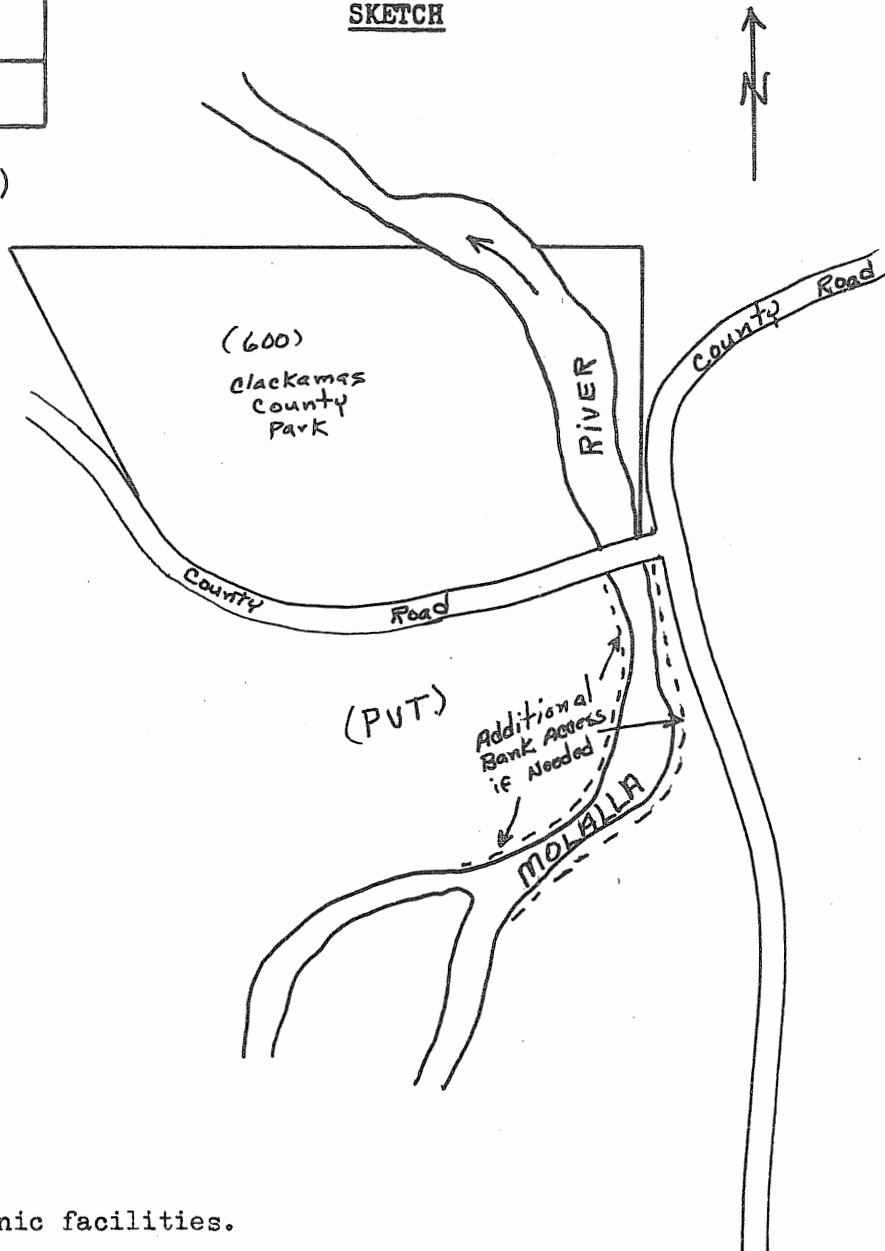

Seasons (Check)

	Spring	Summer	Fall	Winter
	X	X	X	X
	X	X	X	
		X		

RECREATION
(Check)

- Boating, motor
- Boating, non-motor
- Camping, tent
- Camping, trailer
- Fishing, boat
- Fishing, shore
- Hiking
- Horseback riding
- Hunting, big game
- Hunting, upland game
- Hunting, waterfowl
- Nature study
- Picnicking
- Sightseeing
- Skin and scuba diving
- Swimming
- Water skiing

OTHER

Safety Problems:

Group Facilities: Parking and picnic facilities.

REMARKS

Additional bank access may be needed south of the park as use increases in this area.

WATER ACCESS SITE EVALUATION

Pudding River System Site No. 9
II Area Priority B
Name Crown Zellerbach Camp

Location Molalla River - 4 miles southeast of Molalla, Both Banks
T 5 S, R 2 E, Sec. 23 River Mile 22 County Clackamas

Ownership: Public _____
Private X Tax Lot No. 200
Number of owners 1 Crown Zellerbach

DESCRIPTION

Land type Large flat adjacent to river
Cover type Alder, conifers and deciduous brush
Road access Private, Condition Paved
Flows Seasonal fluctuation Water quality Good
Present stage of development None, but used by anglers

ANGLER NEEDS

Acquisition: 1 Acres, 1 mile of frontage
Type of conveyance Purchase easement or use agreement

Development:

Boat ramp: Type _____ Number of lanes _____
Toilets X Trails X Roads _____
Parking area X; For 25 cars or _____ car-trailer units
This site will provide parking and 1 mile of stream for bank anglers
in this popular fishing area.

WATER ACCESS SITE EVALUATION

Pudding River System Site No. 10
II Area Priority B

Name Dickey Prairie to Glen Avon

Location Molalla River - 5 miles southeast of Molalla, Both Banks

T 5 S, R 2 E, Sec. 26 & 36 River Mile 23-26 County Clackamas

Ownership: Public

Private X Tax Lot No. Many

Number of owners Many

DESCRIPTION

Land type Small flats with moderate slopes to river

Cover type Conifer, alder and deciduous brush

Road access County and private, Condition Paved

Flows Seasonal fluctuation Water quality Good

Present stage of development None, but used

ANGLER NEEDS

Acquisition: _____ Acres, _____ of frontage

Type of conveyance _____

Development:

Boat ramp: Type _____ Number of lanes _____

Toilets _____ Trails _____ Roads _____

Parking area X; For 50 cars or _____ car-trailer units

This site should have parking and stream access wherever feasible along this
section of the river.

WATER ACCESS SITE EVALUATION

Name Covered Bridge Crossing

Location Molalla River - 9 miles southeast of Molalla, Both Banks

T 6 S, R 3 E, Sec. 6 River Mile 27 County Clackamas

Ownership: Public

Private X Tax Lot No. 200

Number of owners

DESCRIPTION

Land type Narrow shelf above river

Cover type Conifers and deciduous brush

Road access County and private, Condition Paved

Flows Seasonal fluctuation Water quality Good

Present stage of development None

ANGLER NEEDS

Acquisition: 1/2 Acres, 1/2 mile of frontage

Type of conveyance

Development:

Boat ramp: Type Number of lanes

Toilets Trails Roads

Parking area ; For cars or car-trailer units

This site is the last access available from county road on the east side

of river.

AREA II

SITE # 12

FISHERY: Planted rainbow and native cutthroat trout.

	Spring	Summer	Fall	Winter
Heavy	Tr	Tr		
Medium				
Light			Tr	

(Sa - Salmon, St - Steelhead, Tr - Trout, Sg - Sturgeon, Ww - Warm Water Fishes)

SKETCH

(See Map)

Seasons (Check)

RECREATION
(Check)

- Boating, motor
- Boating, non-motor
- Camping, tent
- Camping, trailer
- Fishing, boat
- Fishing, shore
- Hiking
- Horseback riding
- Hunting, big game
- Hunting, upland game
- Hunting, waterfowl
- Nature study
- Picnicking
- * Sightseeing
- Skin and scuba diving
- Swimming
- Water skiing

	Spring	Summer	Fall	Winter
	X	X	X	
	X	X	X	
	X	X	X	

* Wildlife & geological formations

OTHER

Safety Problems:

Group Facilities:

REMARKS

Parking and access to the stream should be acquired wherever it is feasible along this section of the stream.

AREA III

This area includes the eastern tributaries of the Pudding River with the exception of the Molalla River which has been covered in Area II. These streams originate in the foothills of the Cascade mountains and flow in a northwesterly direction to enter the main stem Pudding River in the Willamette Valley floor. Streams included in this area are Butte Creek, Abiqua Creek, Silver Creek and other minor tributaries. Stream gradient changes from moderate in the upper sections to relatively flat in the valley. Stream flow is good in the spring, but becomes quite low in late summer and early fall.

The fishery in these streams is primarily on stocked rainbow trout and a few native cutthroat trout in the upper reaches in most of the streams. Angling pressure is heaviest in the spring and early summer becoming relatively light in late summer and fall. Abiqua Creek also has a small run of winter steelhead available to the angler in late winter or early spring. The minor tributaries, Bear Creek, Rock Creek, Drift Creek and Upper Pudding River have a very light, early spring, native cutthroat trout fishery utilized primarily by the landowners living along these streams.

The area is quite accessible from public roads, however, extensive private ownership of river frontage requires the angling public to rely on access over private lands which could be closed at any time.

Twelve sites have been evaluated for this area. Three are considered adequate at this time and nine sites are recommended for development to insure angler use of this area.

The following evaluation sheets further describe each site.

AREA III

SITE # 1

FISHERY: Rainbow trout

	Spring	Summer	Fall	Winter
Heavy				
Medium	Tr			
Light		Tr	Tr	

(Sa - Salmon, St - Steelhead, Tr - Trout, Sg - Sturgeon, Ww - Warm Water Fishes)

SKETCH

Seasons (Check)

	Spring	Summer	Fall	Winter
Boating, motor				
Boating, non-motor				
Camping, tent				
Camping, trailer				
Fishing, boat	X	X	X	
Fishing, shore				
Hiking				
Horseback riding				
Hunting, big game				
Hunting, upland game				
Hunting, waterfowl				
Nature study				
Picnicking	X	X	X	
Sightseeing				
Skin and scuba diving				
Swimming		X		
Water skiing				

RECREATION
(Check)

- Boating, motor
- Boating, non-motor
- Camping, tent
- Camping, trailer
- Fishing, boat
- Fishing, shore
- Hiking
- Horseback riding
- Hunting, big game
- Hunting, upland game
- Hunting, waterfowl
- Nature study
- Picnicking
- Sightseeing
- Skin and scuba diving
- Swimming
- Water skiing

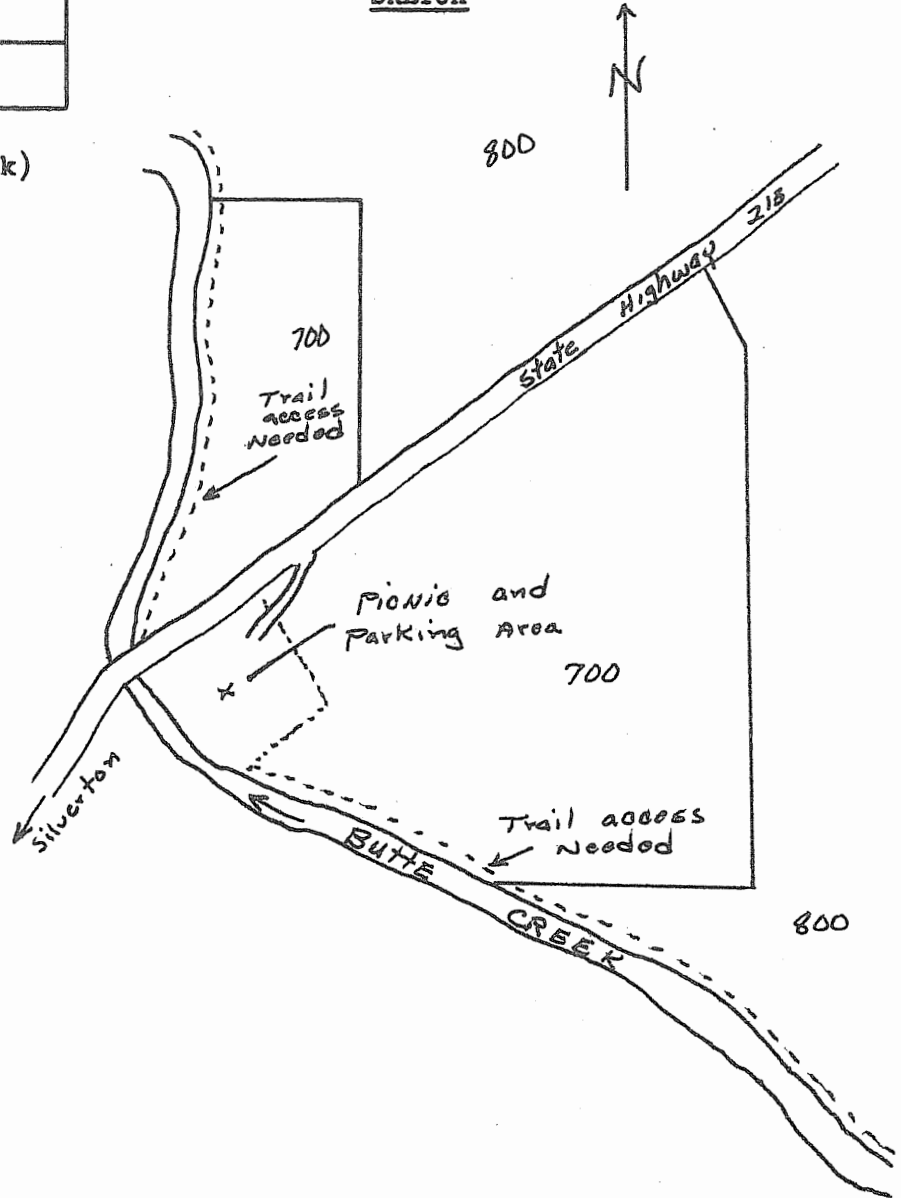

OTHER

Safety Problems:

Group Facilities: Parking and picnic facilities

REMARKS

This is about the lower limit of trout angling in the river. Below this area the combination of reduced stream gradient, lower flows, and resultant high water temperatures, the stream is marginal for trout production.

AREA III

SITE # 2

FISHERY: Rainbow trout

Spring Summer Fall Winter

(Sa - Salmon, St - Steelhead, Tr - Trout, Sg - Sturgeon, Ww - Warm Water Fishes)

Heavy				
Medium	Tr	Tr		
Light			Tr	

SKETCH

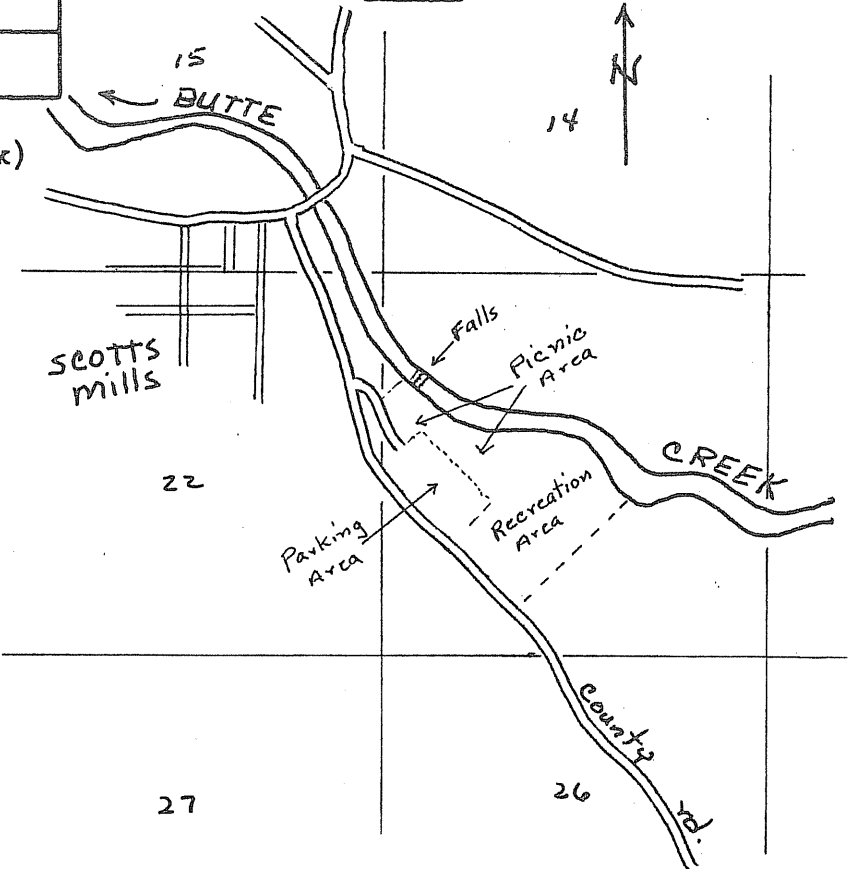

Seasons (Check)

	Spring	Summer	Fall	Winter
	X	X	X	
	X	X	X	
		X	X	

RECREATION
(Check)

- Boating, motor
- Boating, non-motor
- Camping, tent
- Camping, trailer
- Fishing, boat
- Fishing, shore
- Hiking
- Horseback riding
- Hunting, big game
- Hunting, upland game
- Hunting, waterfowl
- Nature study
- Picnicking
- Sightseeing
- Skin and scuba diving
- Swimming
- Water skiing

OTHER

Safety Problems: 21-foot falls at park site

Group Facilities: Parking and picnic facilities

REMARKS

The pool at the bottom of the falls provides an excellent swimming area for adults. A small shallow pool above the falls is available for small children.

WATER ACCESS SITE EVALUATION

Pudding River System Site No. 3
III Area Priority A
Name Cascade Area Access

Location Butte Cr., 3 miles southeast of Scotts Mills, North Bank
T 6 S, R 2 E, Sec. 30 River Mile 19 County Clackamas

Ownership: Public _____
Private X Tax Lot No. 100
Number of owners 1

DESCRIPTION

Land type Small flat and rocky area
Cover type Alder and grass
Road access County, Condition Gravel
Flows Seasonal fluctuational Water quality Good
Present stage of development None

ANGLER NEEDS

Acquisition: 1/2 Acres, 1/2 mile of frontage
Type of conveyance Purchase and easement

Development:

Boat ramp: Type _____ Number of lanes _____
Toilets _____ Trails _____ Roads _____
Parking area X; For 15 cars or _____ car-trailer units

This site will assure bank angling in this section of the stream.

WATER ACCESS SITE EVALUATION

Pudding River System Site No. 4
III Area Priority Complete
Name Boy Scout Camp

Location Butte Cr. 5 miles southeast of Scotts Mills, East Bank
T 6 S, R 2 E, Sec. 32 River Mile 21 County Clackamas

Ownership: Public _____
Private X Tax Lot No. 500
Number of owners 1

DESCRIPTION

Land type Large flat valley
Cover type Fir, alder and deciduous brush with clearings
Road access Private, Condition Gravel
Flows Seasonal fluctuation Water quality Good
Present stage of development Partially developed scout camp

ANGLER NEEDS

Acquisition: _____ Acres, _____ of frontage
Type of conveyance _____

Development:

Boat ramp: Type _____ Number of lanes _____
Toilets _____ Trails _____ Roads _____
Parking area _____; For _____ cars or _____ car-trailer units

A private ranch and summer home has been bought by the Boy Scouts and is being developed into a Boy Scout Youth Camp.

AREA III

SITE # 4

FISHERY: Rainbow trout

Spring Summer Fall Winter

Heavy				
Medium	Tr	Tr		
Light			Tr	

(Sa - Salmon, St - Steelhead, Tr - Trout, Sg - Sturgeon, Ww - Warm Water Fishes)

SKETCH

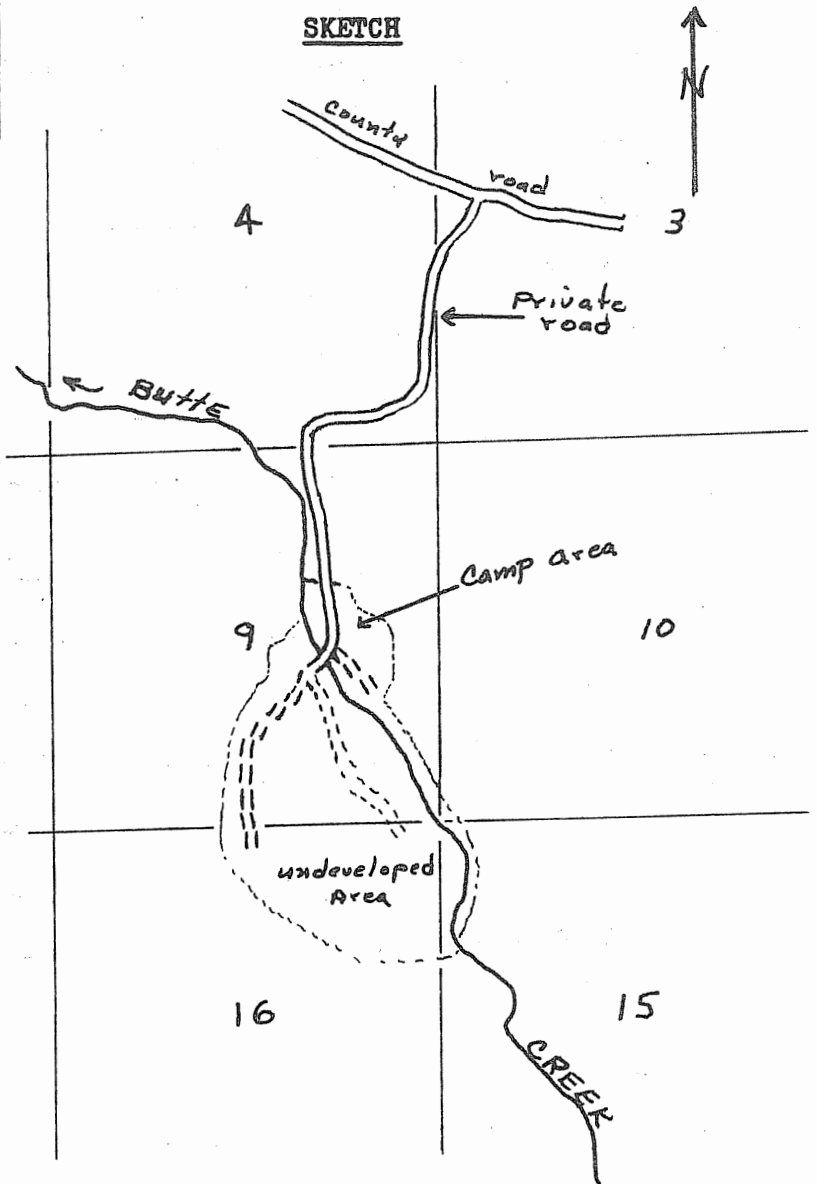

Seasons (Check)

	Spring	Summer	Fall	Winter
	X	X	X	
	X	X	X	
	X	X	X	
	X	X	X	
	X	X	X	
		X		

RECREATION
(Check)

- Boating, motor
- Boating, non-motor
- Camping, tent
- Camping, trailer
- Fishing, boat
- Fishing, shore
- Hiking
- Horseback riding
- Hunting, big game
- Hunting, upland game
- Hunting, waterfowl
- Nature study
- Picnicking
- Sightseeing
- Skin and scuba diving
- Swimming
- Water skiing

OTHER

Safety Problems:

Group Facilities:

REMARKS

This property is owned by the Columbia Pacific Council Boy Scouts of America.

WATER ACCESS SITE EVALUATION

Pudding River System Site No. 5
III Area Priority C
Name Abiqua Bridge access

Location Abiqua Cr. 2 $\frac{1}{2}$ miles north of Silverton, Both Banks
T 6 S, R 1 W, Sec. 24 River Mile 5 County Marion

Ownership: Public _____
Private X Tax Lot No. 4133, 4334
Number of owners 2

DESCRIPTION

Land type Flat farmland
Cover type Alder and deciduous brush
Road access County road, Condition Paved
Flows Seasonal fluctuation Water quality Fair
Present stage of development Highway bridge crossing

ANGLER NEEDS

Acquisition: $\frac{1}{2}$ Acres, 1 $\frac{1}{2}$ miles of frontage
Type of conveyance Purchase and easement

Development:

Boat ramp: Type _____ Number of lanes _____
Toilets X Trails X Roads _____
Parking area X; For 15 cars or _____ car-trailer units

This site is presently being used by anglers. Parking is on the highway
shoulder and access to the stream is across private land.

AREA III

SITE # 5

FISHERY: Rainbow trout

	Spring	Summer	Fall	Winter
Heavy				
Medium	Tr			
Light		Tr	Tr	

(Sa - Salmon, St - Steelhead, Tr - Trout, Sg - Sturgeon, Ww - Warm Water Fishes)

SKETCH

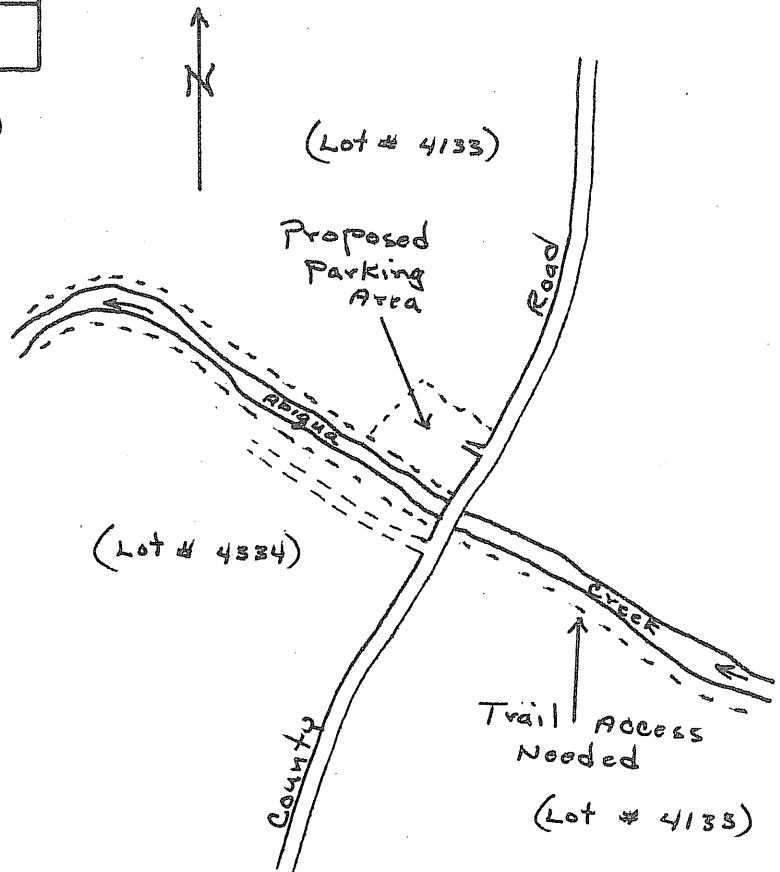

Seasons (Check)

RECREATION
(Check)

	Spring	Summer	Fall	Winter
Boating, motor				
Boating, non-motor				
Camping, tent				
Camping, trailer				
Fishing, boat				
Fishing, shore	X	X	X	
Hiking				
Horseback riding				
Hunting, big game				
Hunting, upland game				
Hunting, waterfowl				
Nature study				
Picnicking				
Sightseeing				
Skin and scuba diving				
Swimming				
Water skiing				

OTHER

Safety Problems:

Group Facilities:

REMARKS

This is the lower limit of trout waters on Abiqua Creek. Reduced flows from irrigation withdrawal and the resultant higher temperatures make the creek unsuitable for trout beyond this site.

WATER ACCESS SITE EVALUATION

Pudding River System Site No. 6
III Area Priority B
Name Dunigan Bridge

Location Abiqua Cr. 9 miles northeast of Silverton, Both Banks
T 6 S, R 1 E, Sec. 34 River Mile 10.5 County Marion

Ownership: Public
Private X Tax Lot No. 21711-1 & 21711
Number of owners 2

DESCRIPTION

Land type Flat with steep banks to river
Cover type Alder, oak and deciduous brush
Road access County, Condition Paved
Flows Seasonal fluctuation Water quality Good
Present stage of development Bridge crossing

ANGLER NEEDS

Acquisition: 1/2 acre for parking and 2 miles of frontage
Type of conveyance Easement or purchase

Development:

Boat ramp: Type _____ Number of lanes _____
Toilets _____ Trails _____ Roads _____
Parking area X; For 10 cars or _____ car-trailer units

This area is one of the two areas on the Abiqua that has a fishery for
steelhead trout.

WATER ACCESS SITE EVALUATION

Pudding River System Site No. 7
III Area Priority A
Name Silverton Dam Site

Location Abiqua Cr. 10 miles northeast of Silverton, North Bank
T 6 S, R 1 E, Sec. 34 River Mile 11 County Marion

Ownership: Public _____
Private X Tax Lot No. 21712, 21712-1
Number of owners 1

DESCRIPTION

Land type Narrow flat between road and river
Cover type Fir, oak, alder and deciduous brush
Road access County, Condition Paved
Flows Seasonal fluctuation Water quality Good
Present stage of development Silverton water supply dam.

ANGLER NEEDS

Acquisition: 1/2 Acre 1 mile of frontage
Type of conveyance Purchase and easement

Development:

Boat ramp: Type _____ Number of lanes _____
Toilets _____ Trails _____ Roads _____
Parking area X; For 15 cars or _____ car-trailer units

This area receives the heaviest angling pressure for steelhead in Abiqua
Creek.

WATER ACCESS SITE EVALUATION

Pudding River System Site No. 8
III Area Priority A
Name Covered bridge access

Location Abiqua Cr. 12 miles northeast of Silverton, Both Banks
T 7 S, R 1 E, Sec. 11 River Mile 12.5 County Marion
Ownership: Public _____
Private X Tax Lot No. 21842, 21862-3
Number of owners 2

DESCRIPTION

Land type Small benches along river with moderate to steep banks
Cover type Fir, alder and deciduous brush
Road access County, Condition Gravel
Flows Seasonal fluctuation Water quality Good
Present stage of development None

ANGLER NEEDS

Acquisition: 1/2 Acre 3 miles of frontage
Type of conveyance Purchase and easement

Development:

Boat ramp: Type _____ Number of lanes _____
Toilets _____ Trails _____ Roads _____
Parking area X; For 20 cars or _____ car-trailer units

This site will assure access for bank angling along this preferred section
of the stream.

AREA III

SITE # 9

FISHERY: Rainbow trout

	Spring	Summer	Fall	Winter
Heavy				
Medium	Tr			
Light		Tr	Tr	

(Sa - Salmon, St - Steelhead, Tr - Trout, Sg - Sturgeon, Ww - Warm Water Fishes)

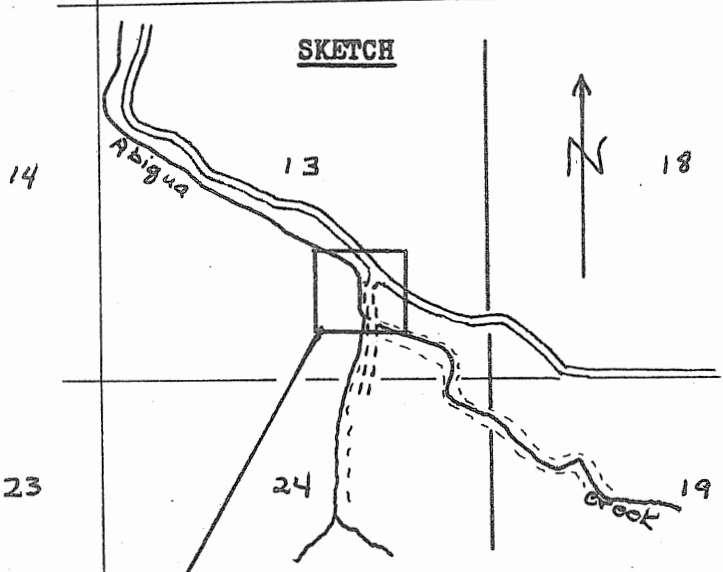

Seasons (Check)

	Spring	Summer	Fall	Winter
	X	X		
	X	X	X	
	X	X	X	
		X		

RECREATION
(Check)

- Boating, motor
- Boating, non-motor
- Camping, tent
- Camping, trailer
- Fishing, boat
- Fishing, shore
- Hiking
- Horseback riding
- Hunting, big game
- Hunting, upland game
- Hunting, waterfowl
- Nature study
- Picnicking
- Sightseeing
- Skin and scuba diving
- Swimming
- Water skiing

OTHER

Safety Problems:

Group Facilities: Parking and picnic facilities.

REMARKS

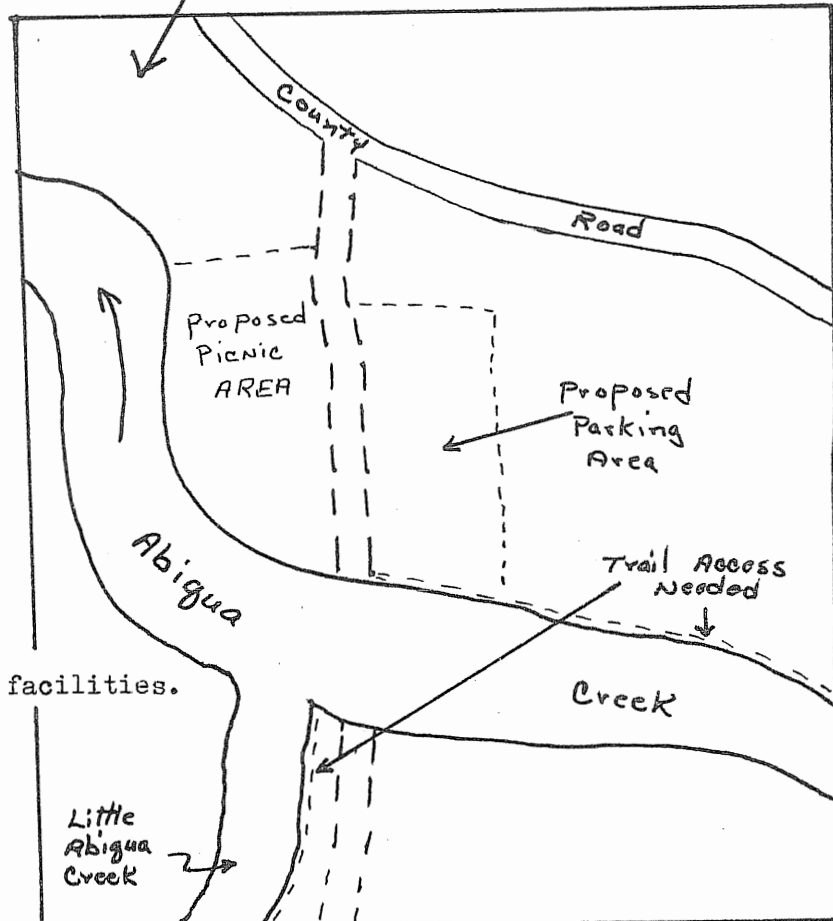

WATER ACCESS SITE EVALUATION

Pudding River System Site No. 10
III Area Priority Complete
Name Silverton City Park

Location Silver Creek at Silverton, West Bank
T 6 S, R 1 W, Sec. 35 River Mile 4 County Marion
Ownership: Public City of Silverton
Private _____ Tax Lot No. 107-490
Number of owners 1

DESCRIPTION

Land type Small flat along river
Cover type Fir, alder and deciduous brush
Road access City street, Condition Paved
Flows Seasonal fluctuation Water quality Fair
Present stage of development Completed city park

ANGLER NEEDS

Acquisition: _____ Acres, _____ of frontage
Type of conveyance _____

Development:

Boat ramp: Type _____ Number of lanes _____
Toilets _____ Trails _____ Roads _____
Parking area _____; For _____ cars or _____ car-trailer units

This is a well developed city park with picnic facilities.

FISHERY: Rainbow trout and cutthroat trout.

	Spring	Summer	Fall	Winter
Heavy	Tr			
Medium		Tr		
Light			Tr	

(Sa - Salmon, St - Steelhead, Tr - Trout, Sg - Sturgeon, Ww - Warm Water Fishes)

SKETCH



Seasons (Check)

	Spring	Summer	Fall	Winter
	X	X	X	
	X	X	X	
		X		

RECREATION
(Check)

- Boating, motor
- Boating, non-motor
- Camping, tent
- Camping, trailer
- Fishing, boat
- Fishing, shore
- Hiking
- Horseback riding
- Hunting, big game
- Hunting, upland game
- Hunting, waterfowl
- Nature study
- Picnicking
- Sightseeing
- Skin and scuba diving
- Swimming
- Water skiing

OTHER

Safety Problems:

Group Facilities: Parking and picnic facilities

REMARKS

This site provides angling for juvenile anglers from the Silverton area.

AREA III

SITE # 11

FISHERY: Native cutthroat trout and potential stocked rainbow trout.

Spring Summer Fall Winter

Heavy				
Medium	Tr			
Light		Tr	Tr	

(Sa - Salmon, St - Steelhead, Tr - Trout, Sg - Sturgeon, Ww - Warm Water Fishes)

SKETCH

Seasons (Check)

	Spring	Summer	Fall	Winter
	X	X	X	
	X	X	X	
			X	X

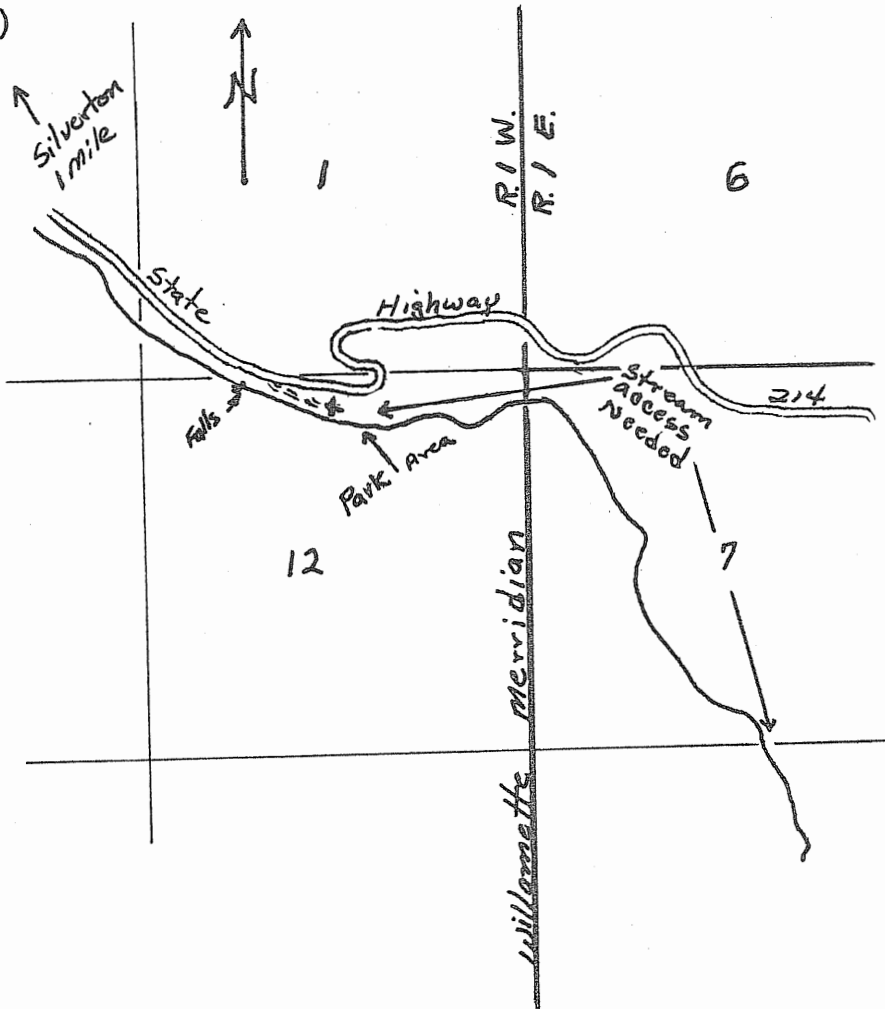

* RECREATION
(Check)

- Boating, motor
- Boating, non-motor
- Camping, tent
- Camping, trailer
- Fishing, boat
- Fishing, shore
- Hiking
- Horseback riding
- Hunting, big game
- Hunting, upland game
- Hunting, waterfowl
- Nature study
- Picnicking
- Sightseeing
- Skin and scuba diving
- Swimming
- Water skiing

* Potential if developed

OTHER

Safety Problems:

Group Facilities: Parking and picnic facilities

REMARKS

The fishery in the river now consists of native cutthroat trout, but if this site were developed rainbow trout could be planted in the area to supplement the present fishery.

WATER ACCESS SITE EVALUATION

Pudding River System Site No. 12
III Area Priority Complete
Name Silver Falls State Park

Location Silver Cr. 26 miles east of Salem, Both Banks
1 E
T 8 S, R 2 E, Sec. Many River Mile 16-25 County Marion
Ownership: Public State Highway Department
Private _____ Tax Lot No. _____
Number of owners 1

DESCRIPTION

Land type Mountainous, small flats and deep gorges
Cover type Fir, deciduous trees and shrubs
Road access State Highway, Condition Paved
Flows Seasonal fluctuations Water quality Good
Present stage of development Complete established park

ANGLER NEEDS

Acquisition: _____ Acres, _____ of frontage
Type of conveyance _____

Development:

Boat ramp: Type _____ Number of lanes _____
Toilets _____ Trails _____ Roads _____
Parking area _____; For _____ cars or _____ car-trailer units
This site attracts many visitors from state wide as well as numerous
tourists from out of state.

FISHERY: Rainbow trout and cutthroat trout

	Spring	Summer	Fall	Winter
Heavy				
Medium	Tr			
Light		Tr	Tr	

(Sa - Salmon, St - Steelhead, Tr - Trout, Sg - Sturgeon, Ww - Warm Water Fishes)

SKETCH

Seasons (Check)

	Spring	Summer	Fall	Winter
Boating, motor				
Boating, non-motor				
Camping, tent	X	X	X	
Camping, trailer	X	X	X	
Fishing, boat				
Fishing, shore	X	X	X	
Hiking	X	X	X	X
Horseback riding				
Hunting, big game				
Hunting, upland game				
Hunting, waterfowl				
Nature study				
Picnicking	X	X	X	
* Sightseeing	X	X	X	X
Skin and scuba diving				
Swimming				
Water skiing				

RECREATION
(Check)

- Boating, motor
- Boating, non-motor
- Camping, tent
- Camping, trailer
- Fishing, boat
- Fishing, shore
- Hiking
- Horseback riding
- Hunting, big game
- Hunting, upland game
- Hunting, waterfowl
- Nature study
- Picnicking
- * Sightseeing
- Skin and scuba diving
- Swimming
- Water skiing

* 9 large falls, within the State park area, that are joined by a well kept trail system.

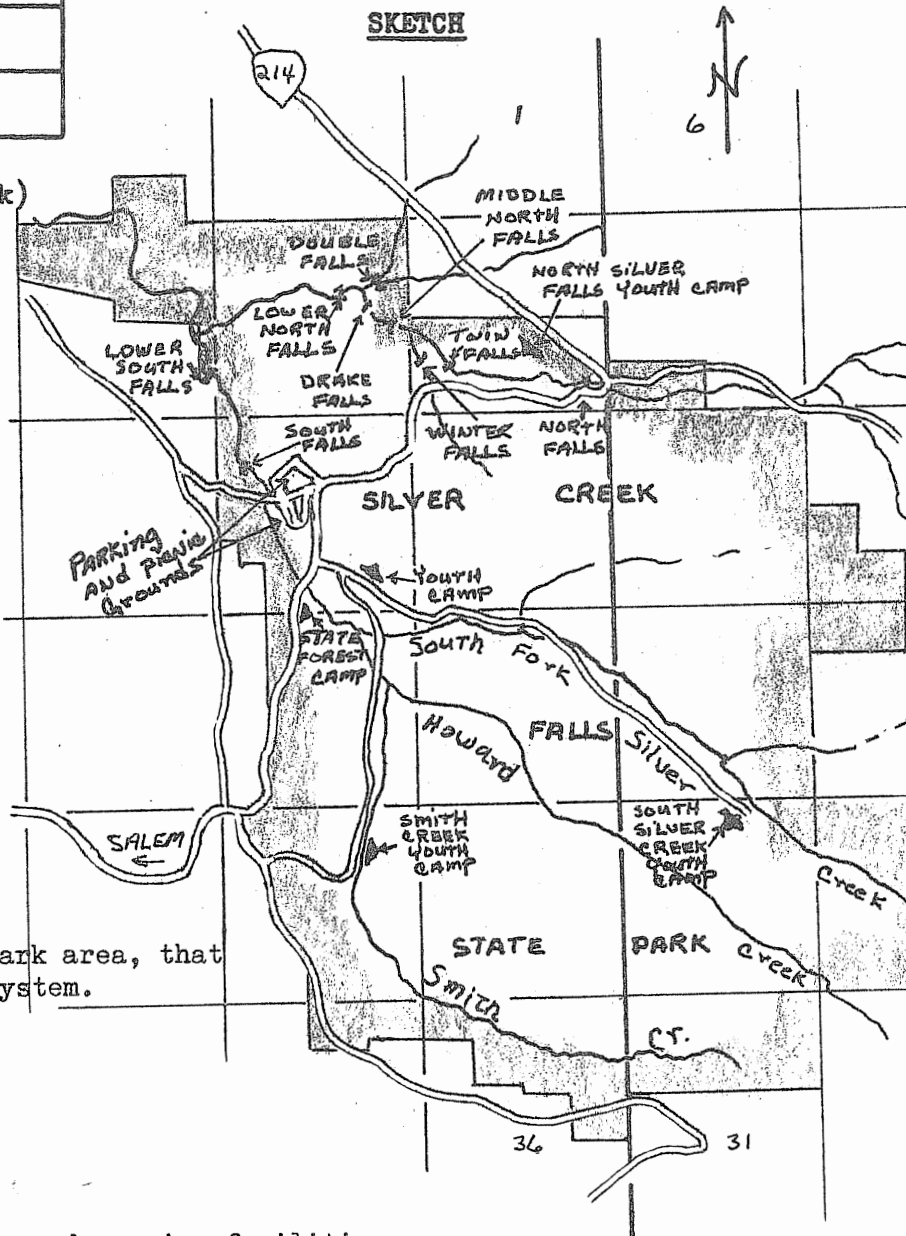

OTHER

Safety Problems:

Group Facilities: Parking, picnic and camping facilities.

REMARKS

This is a large State park of over 8,200 acres with a large picnic and parking area, overnight camping, and trailer facilities, as well as four youth camps. The majority of the angling is by the youth camp groups.

